

| Pos. Nr. Pos.no. | Beschreibung Description | Art.-Nr. Art.no. | Preisgruppe Price bracket |
|-------------------------------|---|---------------------|------------------------------|
| 714407 SNCF BR 044 = N | | | |
| 714477 = N | | | |
| 1 | LOKGEHÄUSE KPL. Loco body assy. complete | 10714407 | 29 |
| 2 | UMLAUFBLECH KPL. Running board | 11714407 | 27 |
| 3 | TS - TREPPEN, Part set - Steps, | 146786 | 8 |
| 4 | TS - ZUGHAKEN Part set - coupling hooks | 19714401 | 14 |
| 5 | REICHSBAHNLAMPE (LOK) Reichsbahn lamp | 197144022 | 6 |
| 6 | TS - RAHMENTEIL,LUFTBEHÄLTER Part set - Frame part, air tank | 146785 | 9 |
| 7 | SCHNECKE Worm gear | 56762510 | 6 |
| 8 | LEITER LI.+RE.+TREPPE-SATZ Ladder L+R + steps - set | 22714401 | 6 |
| 9 | LOKFAHRGESTELL MIT RÄDERN Loco chassis with wheels | 31714407 | 31 |
| 10 | STEUERUNG KPL.M.KREUZKÖPFEN Reversing gear complete | 32714407 | 28 |
| 11 | DECKPLATTE UNTEN (LOK) Lower cover plate | 33714407 | 3 |
| 12 | VORLAUF + AUSTECKTEIL Front bogie + plug-out part | 37714407 | 7 |
| 13 | ADAPTER Adaptor | 145073 | 5 |
| 14 | ZYLINDERKASTEN -SATZ Cylinder box - set | 48714407 | 9 |
| 15 | MOTOR Motor | 50714401 | 28 |
| 16 | BLECHSCHRAUBE Tapping screw | 00713309 | 1 |
| 17 | MOTORHALTER Motor retainer clip | 50792400 | 3 |
| 18 | KONTAKTFEDER MIT BOLZEN Contact spring with bolt | 61793400 | 4 |
| 19 | LEITERPLATTE KPL. (LOK+LICHT) PCB complete | 65724600 | 20 |
| 20 | LEITERPLATTE KPL. PCB complete | 65724800 | 12 |
| 21 | BRÜCKENSTECKER Bridge | 66710900 | 18 |
| 22 | STECKPUFFER (GEWÖLBT) Plug-in buffer (curved) | 00757011 | 2 |
| 23 | STECKPUFFER (FLACH) Plug-in buffer (flat) | 00757012 | 2 |
| 24 | LINSENSCHRAUBE M1,6x2/4,8 mm Button screw | 00704902 | 2 |
| 25 | LINSENSCHRAUBE Button screw | 00704904 | 2 |
| Sound | | | |
| 26 | LAUTSPRECHER Loudspeaker | 68702500 | 16 |
| 27 | LAUTSPRECHERAUFNAHME Loudspeaker reception | 68702700 | 4 |
| 28 | SOUNDECODER Sound decoder | 68714477 | 40 |
| 29 | UMLAUFBLECH KPL. Running board | 11714477 | 27 |

Änderungen in Konstruktion und Ausführung vorbehalten
We reserve the right to change the construction and specification

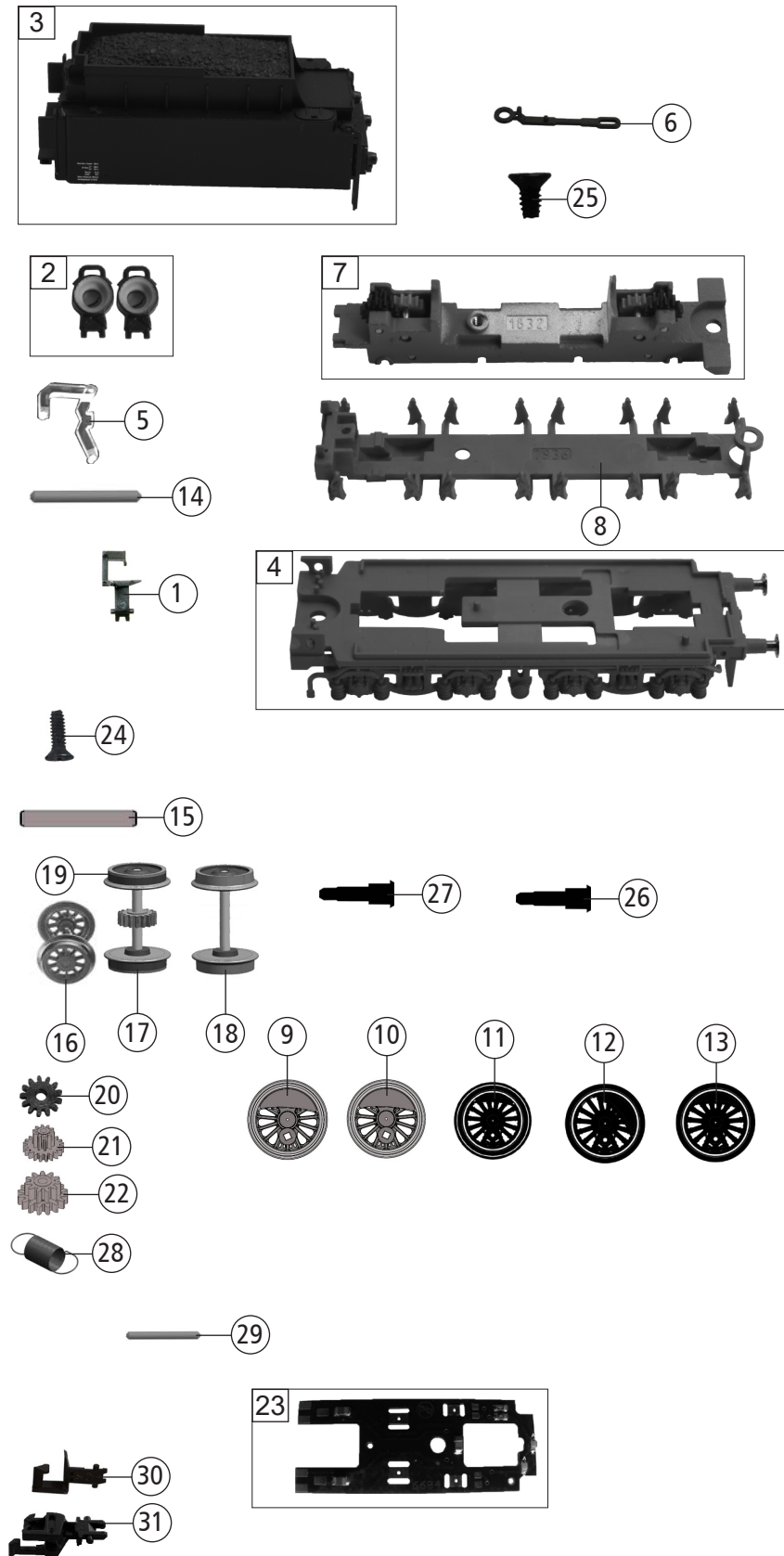

| Pos. Nr. Pos.no. | Beschreibung Description | Art.-Nr. Art.no. | Preisgruppe Price bracket |
|---------------------|---|---------------------|------------------------------|
| 714407 | SNCF BR 044 | = | N |
| 714477 | | = | N |
| 1 | KUPPLUNG N-SPUR Coupling | 98189 | 6 |
| 2 | TS - REICHSBAHNLAMPEN Part set - REICHSBAHN lamps | 144681 | 10 |
| 3 | TENDERGEHÄUSE KPL. Tender body assy. complete | 20714407 | 25 |
| 4 | TENDERRAHMEN KPL. Tender frame complete | 21714407 | 12 |
| 5 | LICHTLEITER (tender) Light conductor | 144684 | 4 |
| 6 | DEICHSEL Short coupling reception | 38806900 | 7 |
| 7 | TENDERFAHRGESTELL Tender framework | 41714407 | 19 |
| 8 | DECKPLATTE UNTEN (TENDER) Lower cover plate | 43714407 | 4 |
| 9 | TREIBRAD LI. Driving wheel L. | 51718210 | 7 |
| 10 | TREIBRAD RE. Driving wheel R. | 51718310 | 7 |
| 11 | KUPPELRAD Coupled wheel | 51718410 | 7 |
| 12 | KUPPELRAD Coupled wheel | 51718510 | 7 |
| 13 | KUPPELRAD Coupled wheel | 51718610 | 7 |
| 14 | ACHSE Axle | 00527009 | 1 |
| 15 | RADACHSE Axle for wheels | 52701300 | 5 |
| 16 | RADSATZ KPL. (VORLAUF) Wheelset complete | 53718310 | 13 |
| 17 | RADSATZ KPL.M.Z.M.N. Wheelset comp. w. gearwh. w. groove | 53718410 | 11 |
| 18 | RADSATZ KPL. O.Z.O.N. Wheelset comp. w/o gearwh.w/o groove | 53718510 | 10 |
| 19 | HAFTREIFEN Traction tyre | 00547001 | 1 |
| 20 | UNTERSETZUNGSRAD Z:14/9 Reduction gear wheel | 00567145 | 6 |
| 21 | UNTERSETZUNGSRAD Z:20/10 Reduction gear wheel | 86496 | 3 |
| 22 | UNTERSETZUNGSRAD Z:16/11 Reduction gear wheel | 56720100 | 4 |
| 23 | LEITERPLATTE KPL. (TENDER) PCB complete | 65724700 | 17 |
| 24 | GF-SCHRAUBE GF - screw | 115269 | 3 |
| 25 | SK-SCHRAUBE SK - screw | 125023 | 3 |
| 26 | BOLZEN F. KUPPELSTANGE Bolt for coupling rod | 00730562 | 2 |
| 27 | BOLZEN F. KUPPELSTANGE Bolt for coupling rod | 00730570 | 1 |
| 28 | ZUGFEDER Draw spring | 109832 | 3 |
| 29 | Zahnradachse Wheel axle | 144134 | 4 |
| 30 | STANDARD STECKKUPPLUNG Standard plug-in coupling | 9525 | --- |
| 31 | PROFI STECKKUPPLUNG Pro plug-in coupling | 9545 | --- |